

Tree works following visit by PCC Tree Officer Mr Barry McKee

Please note that the maps are not printed to scale but are indicative only.

Position of trees on mapping is for rough guidance only. Location co-ordinates have been provided for accuracy and all trees have been marked with an appropriate spray

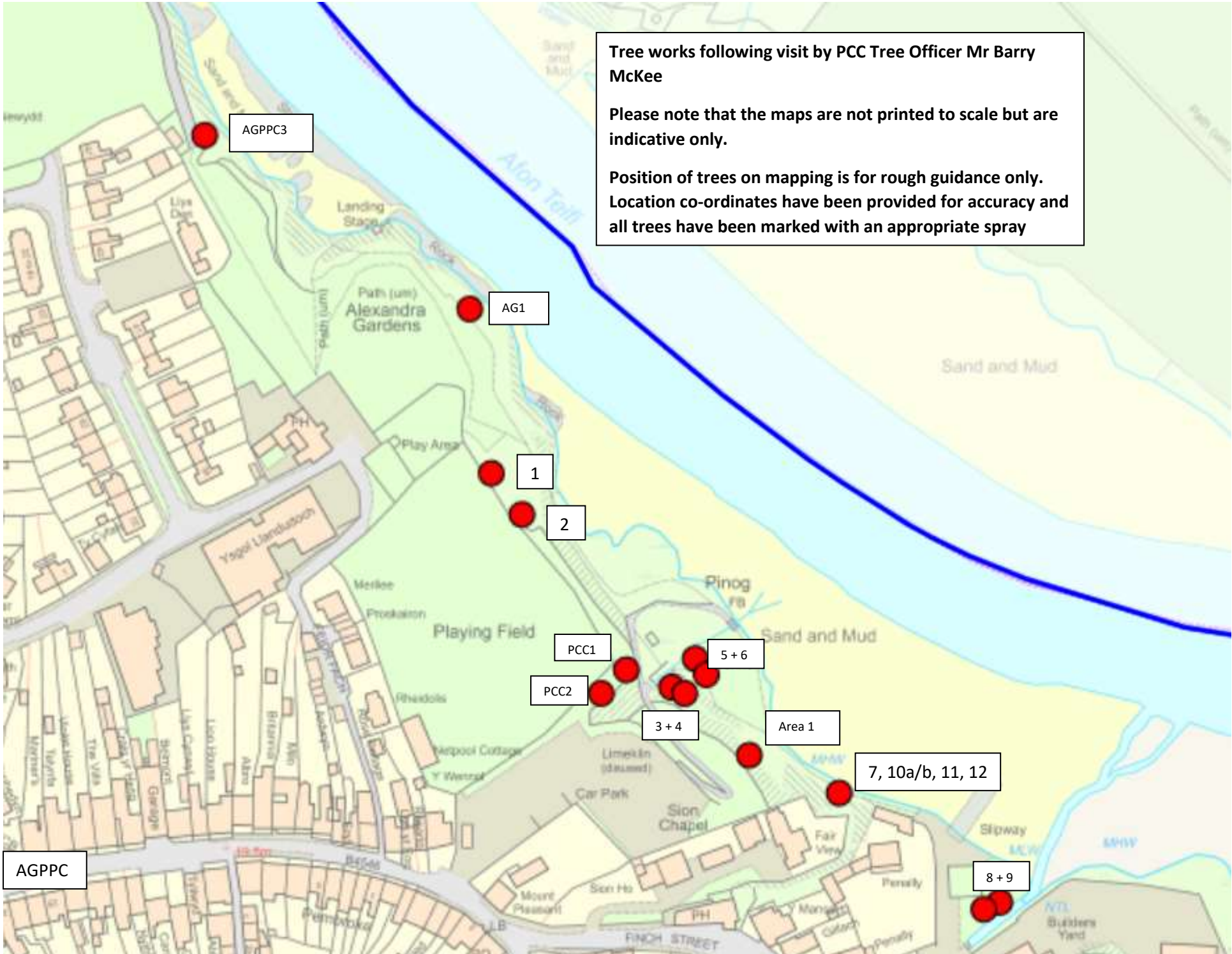

AGPPC

AGPPC3

AG1

1

2

PCC1

PCC2

5+6

3+4

Area 1

7, 10a/b, 11, 12

8+9

October 2021

Marked	Location	Ownership	Species	Action
1	SN 16514611	SD	Ash	Remove lower branches overhanging path
2	SN 16494612	SD	Hazel	Remove one branch across footpath
				Oak split with hazel growing through it. Obvious rot with fungi present.
PCC1	SN 16504608	SD	Oak	Reduce height by 2/3.
PCC2	SN 16504608	SD	Ash	Monitor
Area 1	SN 16534603	PCC	Ash and elm	Area not easily accessible to public - monitor
3	SN 16524609	SD	Ash	Monitor
4	SN 16524609	SD	Ash	Monitor
5	SN 16534608	SD	Ash	Lower to approx. 5m height
6	SN 16544608	SD	Ash	Remove
7	SN 16574605	SD		Remove low branch overhanging footpath
8	SN 66644599	SD	Ash	Remove
9	SN 16644599	SD	Ash	Monitor
AG1	SN 16454617	SD	Ash	No significant signs of dieback - monitor
AGPPC3	SN 16454617	SD	Ash	Monitor
10a/b	As 7	SD	Elm	Remove multiple trunk and single trunk to rear
11	As 7	SD	Elm	Monitor
12	As 7	SD	Elm	Monitor



Map showing SSSI boundary

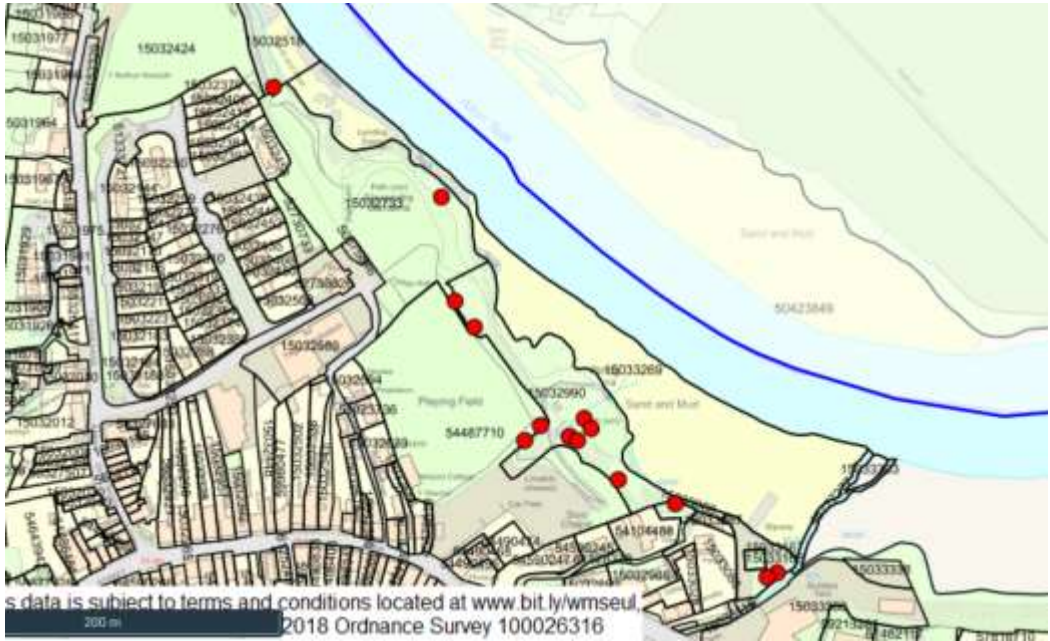

Map showing land registry boundaries.

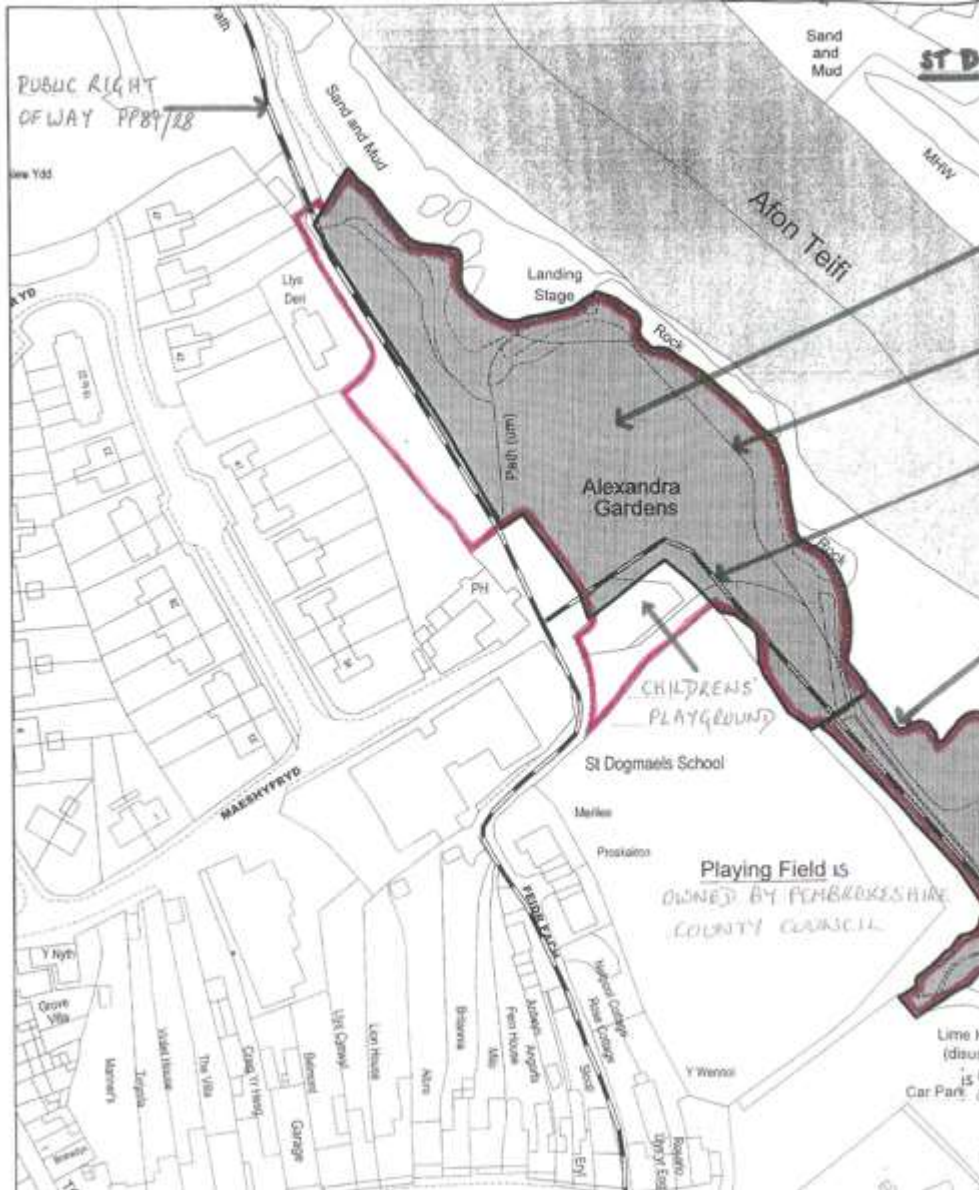

Maps showing boundary of village green registered in the ownership of St Dogmaels Community Council

